

POLE MOUNTING SYSTEM

INTERLOCKING ARM & FITTERS PROVIDES POSITIVE NON-ROTATING POSITIONING OF PIPE ARM FOR ALL OUTDOOR POLE AND WALL MOUNTED LOWERING SYSTEMS

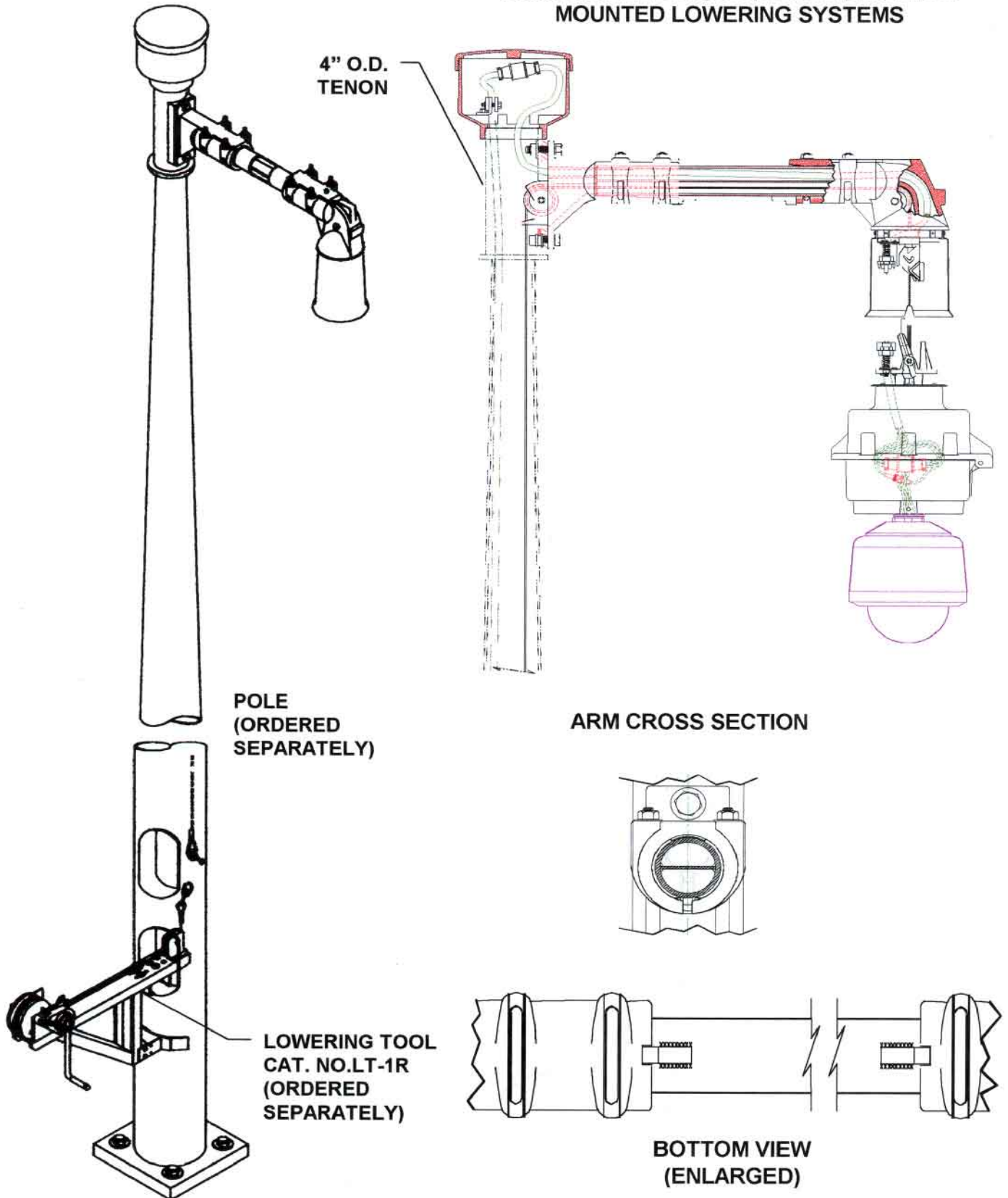

FOR POLE INSTALLATION

1. Pole configuration (please check one):

- Round Tapered Pole (RT)
- Round Straight Pole (RS)
- Squared Tapered Pole (ST)
- Squared Straight Pole (SS)

2. Pole material Specification:

- Steel (S)
- Aluminum (A)
- Concrete (C)
- Fiberglass (F)

3. Pole height: _____

4. Finish – Steel poles:

- Painted Bronze (BRZ)

Optional:

- Galvanized (GV)
- Painted (Specify Color) _____

Finish – Aluminum Poles:

- Natural (NAT)

Optional:

- Clear Anodize (ANCL)
- Bronze Anodize (ANBZ)
- Painted (Specify Color) _____

** Consult Factory for Concrete and Fiberglass pole finishes.

5. Pole Options:

- Nut Cover (NC)
- Base Covers (BC)
- Transformer Base (TB)
- Other

Example (Catalog number):

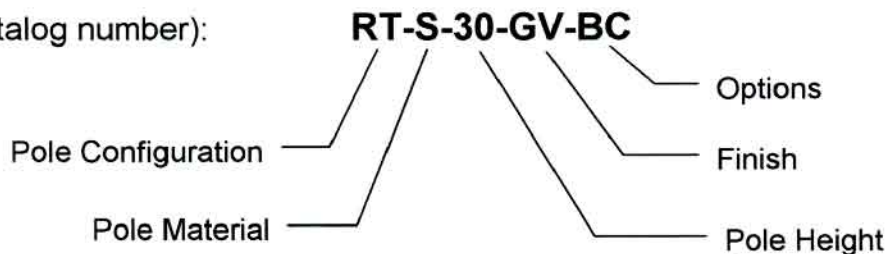

Example defined: Round Tapered, Steel, 30ft Pole Height, Galvanized, Base Cover